

Through-post configuration

| COD. | L | Wt. |
|---------------------|-----|---------------------|
| HFC18.102-5 | 5' | .15 kgs (.331 lbs) |
| HFC18.102-10 | 10' | .227 kgs (.5 lbs) |
| HFC18.102-15 | 15' | .303 kgs (.669 lbs) |
| HFC18.102-20 | 20' | .383 kgs (.844 lbs) |
| HFC18.102-25 | 25' | .549 kgs (1.2 lbs) |

Outside to outside
Level/balcony or angle/stair
Steel or wood posts

Drill Kit [AX00.070.630](#)
[AX00.070.635](#) Page 70

Pre-assembled kit includes fittings and factory swaged cable in lengths 5'-25'



Included in kit



MINIMUM BREAKING STRENGTH - Cable Diameter 1/8" = 1,780 lbs.
1X19 STRAND TYPE 316 STAINLESS STEEL CABLE

1 x 19 Cable - 1/8" Diameter

Cable Cutter



Page 71

Cable cut-off wheel



Page 71

Used to cut cable flush with the end of Pull-Lock fittings, and to cut excess threads of stud. Includes mandrel and two cut-off wheels.

Tension each row of cable equally to 225 lbs making sure not to over tighten. Use tension gauge to accurately measure tension.

Tension Gauge
Page 71

Recommended Tensioning Sequence

EASY AS 1-2-3

- 1.** What posts are you using? Wood or metal?
- 2.** Measure your level and stair runs, calculate number of level and stair fittings.
- 3.** Add up tensioners and non-tensioners, then calculate total cable footage (plus 5%).

Push-Lock[®] Fittings

Push-Lock fittings do not require any special tools for installation. Simply push the cable into the fitting and it locks.



SWAGELESS CABLE INFILL FOR WOOD OR METAL POSTS

Non-Tensioner

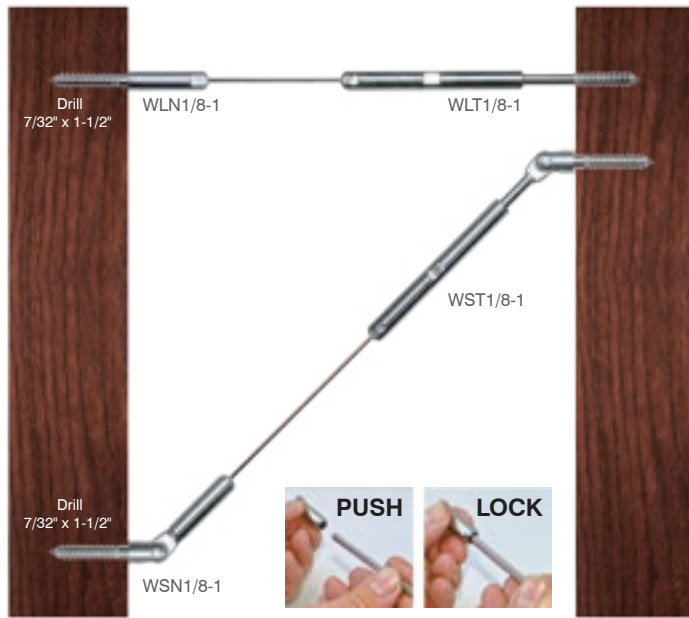

Surface-mount configuration



For use with 1/8" cable

| COD. | Description | Wt. |
|------------------|-----------------------------------|--------------------|
| WLN1/8-1 | Wood Level Non Tensioner | .04 kgs (.092 lbs) |
| WLN1/8-10 | Wood Level Non Tensioner(10 pack) | .31 kgs (.693 lbs) |
| WLT1/8-1 | Wood Level Tensioner | .07 kgs (.173 lbs) |
| WLT1/8-10 | Wood Level Tensioner(10 pack) | .68 kgs (1.5lbs) |
| WSN1/8-1 | Wood Stair Non Tensioner | .06 kgs (.135 lbs) |
| WSN1/8-10 | Wood Stair Non Tensioner(10 pack) | .5 kgs (1.12 lbs) |
| WST1/8-1 | Wood Stair Tensioner | .09 kgs (.217 lbs) |
| WST1/8-10 | Wood Stair Tensioner(10 pack) | .88 kgs (1.94 lbs) |

Inside to inside
Level/balcony or angle/stair
Wood posts

Cable Cutter



Driver



Page 71

Drill Kit **AX00.070.625**
Page 70

Page 71

Non-Tensioner

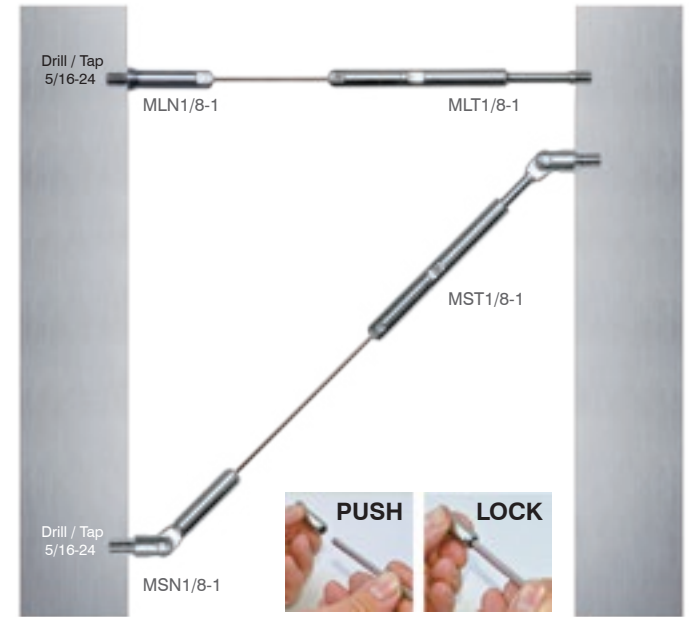

Surface-mount configuration

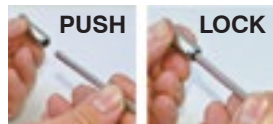

For use with 1/8" cable

| COD. | Description | Wt. |
|------------------|------------------------------------|---------------------|
| MLN1/8-1 | Metal Level Non Tensioner | .04 kgs (.087 lbs) |
| MLN1/8-10 | Metal Level Non Tensioner(10 pack) | .29 kgs (.638lbs) |
| MLT1/8-1 | Metal Level Tensioner | .07 kgs (.158 lbs) |
| MLT1/8-10 | Metal Level Tensioner(10 pack) | .61 kgs (1.349 lbs) |
| MSN1/8-1 | Metal Stair Non Tensioner | .05 kgs (.118 lbs) |
| MSN1/8-10 | Metal Stair Non Tensioner(10 pack) | .6 kgs (1.349 lbs) |
| MST1/8-1 | Metal Stair Tensioner | .09 kgs (.202 lbs) |
| MST1/8-10 | Metal Stair Tensioner(10 pack) | .81 kgs (1.793 lbs) |

Inside to inside
Level/balcony or angle/stair
Metal posts

Cable Cutter



Page 71

Drill Kit **AX00.070.650**
AX00.070.645 Page 70



AISI 316

| COD. | Description | Wt. |
|---------------------|---|----------------------|
| UTCABLE100-4 | 100' coil - 1/8" 1X19 type 316 S/S cable | 2.07 kgs (4.56 lbs) |
| UTCABLE500-4 | 500' spool - 1/8" 1X19 type 316 S/S cable | 10.02 kgs (22.1 lbs) |

1x19 Cable(1/8" 316)

**MINIMUM BREAKING STRENGTH - Cable Diameter 1/8" = 1,780 lbs.
1X19 STRAND TYPE 316 STAINLESS STEEL CABLE**



For use with 4mm cable

| COD. | G | mm | L1 | L2 | L3 | D | A | kg/100 |
|----------------------------|----|-----|------|------|------|-----|-----|--------|
| AX00.050.221SX.B.SP | M6 | 4.0 | 88.0 | 30.0 | 50.0 | 7.0 | 4.5 | 1.2 |

Left handed cable terminal stud (SX)

| | | | | | | | | |
|----------------------------|----|-----|------|------|------|-----|-----|-----|
| AX00.050.220DX.B.SP | M6 | 4.0 | 88.0 | 30.0 | 50.0 | 7.0 | 4.5 | 1.2 |
|----------------------------|----|-----|------|------|------|-----|-----|-----|

Right handed cable terminal stud (DX)



Weight:
.016 kgs (.035 lbs)

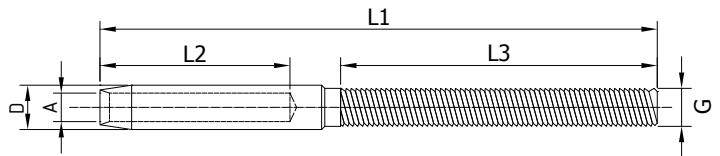

Hydraulic crimper



Page 72

Cable Cutter



Page 71

Drill Kit **AX00.070.610**
Page 70

| COD. | NV | G | kg/100 |
|----------------------------|----|----|-----------|
| AX00.050.231SX.B.SP | 10 | M6 | 0.9 LEFT |
| AX00.050.230DX.B.SP | 10 | M6 | 0.9 RIGHT |

Threaded nut cap tensioners

Weight:
.006 kgs (.013 lbs)

Drill Kit **AX00.070.610**
Page 70

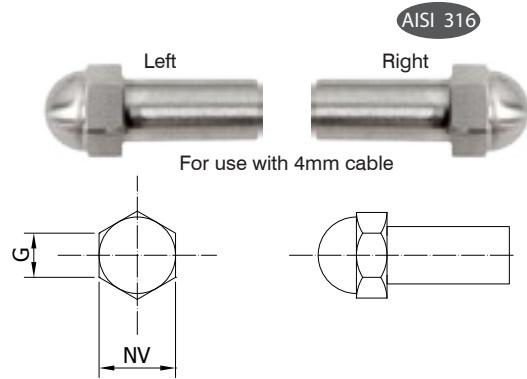

| COD. | NV | G | kg/100 |
|----------------------------|----|----|-----------|
| AX00.050.233SX.B.SP | 12 | M6 | 0.9 LEFT |
| AX00.050.232DX.B.SP | 12 | M6 | 0.9 RIGHT |

Threaded allen head cap tensioners

Weight:
.006 kgs (.013 lbs)

Drill Kit **AX00.070.610**
Page 70

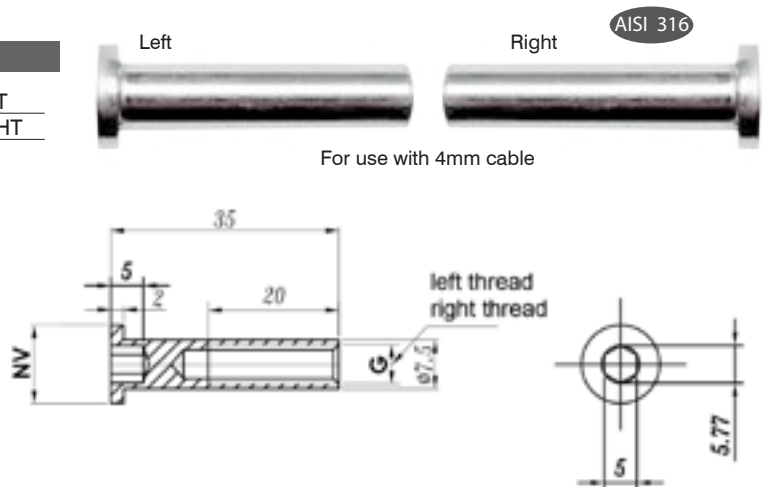

Through-post configuration

| COD. | d | Ø | e |
|--------------------------|-------|---------|------------|
| AX20.060.245.B.SP | 12 mm | 42.4 mm | 14 mm FLAT |

Sloping washer **Weight:** .006 kgs (.013 lbs)

AISI 316

Recommended for runs over 25'

For use with 4mm cable

| COD. | G | L1 | D1 | kg/100 |
|--------------------------|----|------|------|--------|
| AX00.050.235.B.SP | M6 | 65.0 | 10.0 | 1.7 |

Middle-tensioning body **Weight:** .025 kgs (.055 lbs)

AISI 316

Requires use of left and right hand cable terminal studs (not included).

Right hand AX00.050.220DX.B.SP Left hand AX00.050.221SX.B.SP

Through-post configuration

AISI 316

| COD. | Description |
|-------------------------|---|
| AX00.040.215.B.M | 328' Spool - 4 mm 1X19 type 316 S/S cable |

1x19 Cable - Bulk(4MM 316)

Weight: 8.5 kgs (18.73 lbs)

Available in 328' spool